

# TOWNSHIP 1 S., RANGES 10 & 11 W.W.M. TILLAMOOK COUNTY ORE.

DATED FEB. 1974

(36) Bay City Sch. Dt. 31 To Hobsonville

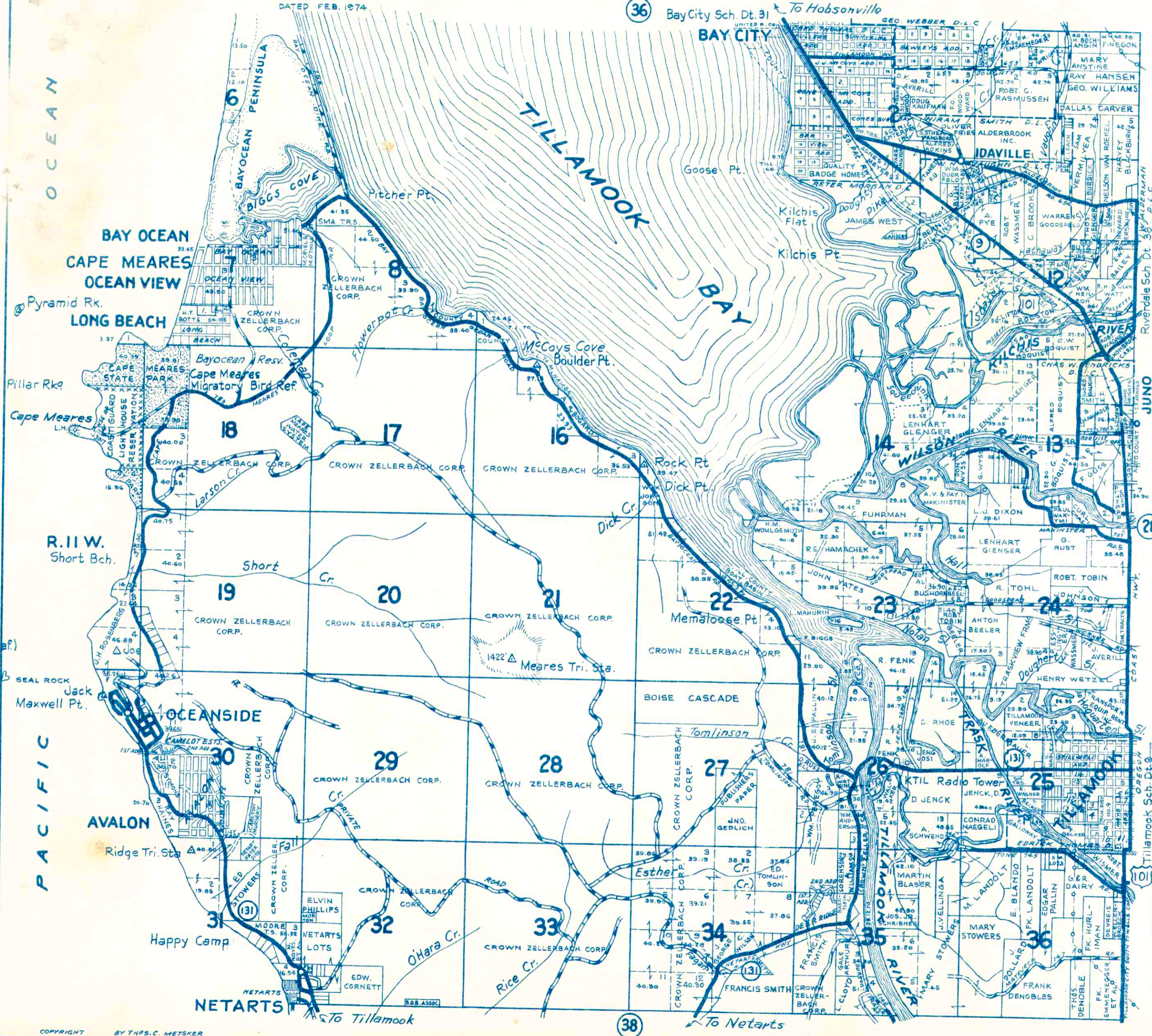

### SMALL TRACTS

- SEC. 2
- 1. A. PETERSON
- 2. WOODS SUB.
- SEC. 7
- 1. SEA CLIFF ESTS.
- 2. BOGARD TERRACES
- 3. REEDER'S SUB.
- SEC. 11
- 1. FRANK MALGIERI
- 2. J.F. FREEMAN
- SEC. 12
- 1. P. ESLINGER
- SEC. 13
- 1. ELMER DEWELL
- 2. GLEN ZUERCHER
- SEC. 25
- 1. TILLAMOOK
- 2. STILLWELL PARK ADD.
- 3. YAGER'S SUBD.
- 4. PARKWAY MANOR SUBD.
- 5. CENTRAL ADD.
- 6. HARTERS "
- 7. MARTINYS "
- 8. KINGS "
- 9. SUNNY MEAD ADD.
- 10. NORTONS "
- 11. DREWS "
- 12. FAIRLANE "
- 13. SHIVELEY'S SUB.
- 14. MAPLEDALE ADD.
- 15. MEADOWLARK ESTS.
- SEC. 26
- 1. M. SCHMITZ
- 2. LURLEEN LEMERY
- 3. H. GRUBER

Reproduction in whole  
or part for personal use or  
resale is prohibited by law.

### LEGEND

- STATE HWY. (6) U.S. HWY. (101)
- PAVED HIGHWAYS
- IMPROVED DIRT ROADS
- DIRT ROADS
- INFERIOR ROADS
- RAILROADS
- TRAILS
- INTERMITTENT CREEKS
- NAT'L FOREST BDRYS XXXXXX
- ELEC. PWR. TRANS. LINES